

TDP CONNECTIONS:  
CAST IN ANCHOR (MIN 2 PER PIECE)  
  
COIL ROD SCREWED INTO INSERT ABOVE AND GRouted SOLID INTO HOLE BELOW.

TDP CONNECTIONS:  
CAST IN ANCHOR (MIN 2 PER PIECE)  
  
BOLT STRAP ANCHOR TO INSERT AND BOLT TO CMU WALL.

MIDDLE CONNECTIONS:  
CAST IN ANCHOR (MIN 2 PER PIECE)  
  
COIL ROD SCREWED INTO INSERT ABOVE AND GRouted SOLID INTO HOLE BELOW.

MIDDLE CONNECTIONS:  
CAST IN ANCHOR (MIN 2 PER PIECE)  
  
BOLT STRAP ANCHOR TO INSERT AND BOLT TO CMU WALL.

BOTTOM CONNECTIONS:  
L-ANCHOR GRouted SOLID IN SLOT AND BOLT TO CIP BACKUP, MIN. 2 PER PIECE

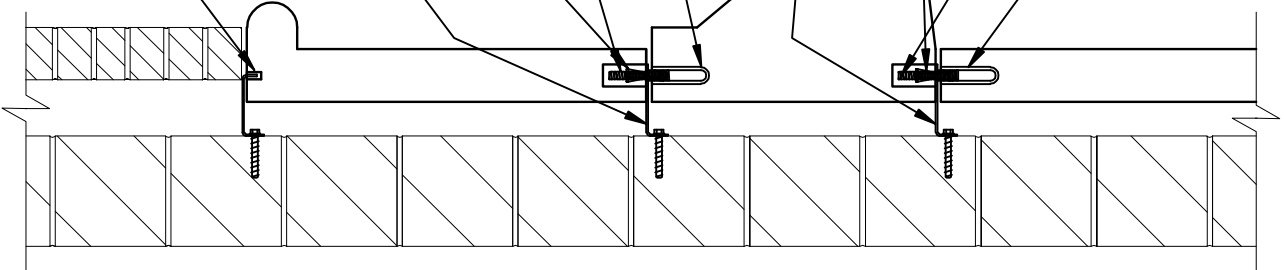

**2**  
BAND CONNECTION  
SCALE: 1"=1'-0"

