

TOP CONNECTION:
SPLIT-TAIL GRouted
SOLID IN PROVIDED
SLOT AND SCREW BACK
TO STUD BACKUP
STRUCTURE.

REBAR AS REQUIRED

BOTTOM CONNECTION:
COIL CAST-IN INSERT
COIL ROD SCREW TO
CAST-IN INSERT AND
GRout SOLID IN FIELD
DRILLED HOLE IN
FOUNDATION BELOW.

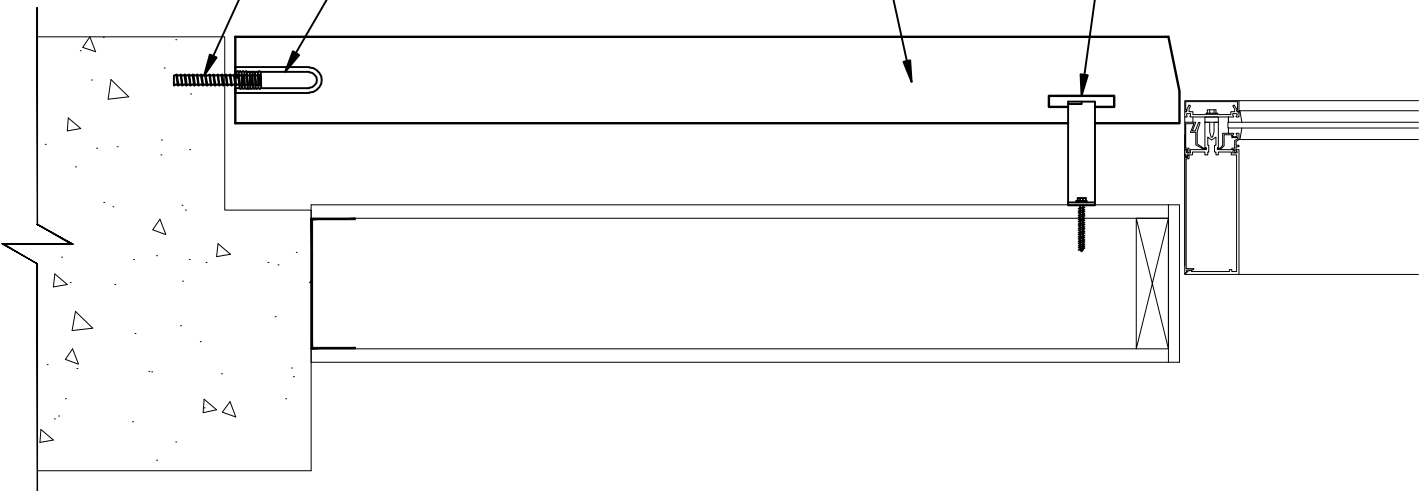

4
BP

BASE PANEL CONNECTION

SCALE: 1-1/2"=1'-0"

