

REBAR AS REQUIRED

TOP AND BOTTOM CONNECTION:
L-ANCHORS GROUTED SOLID IN
SLOT AND SCREW TO STUD
BACKUP, 2 PER TOP AND BOTTOM @
5TH POINTS.

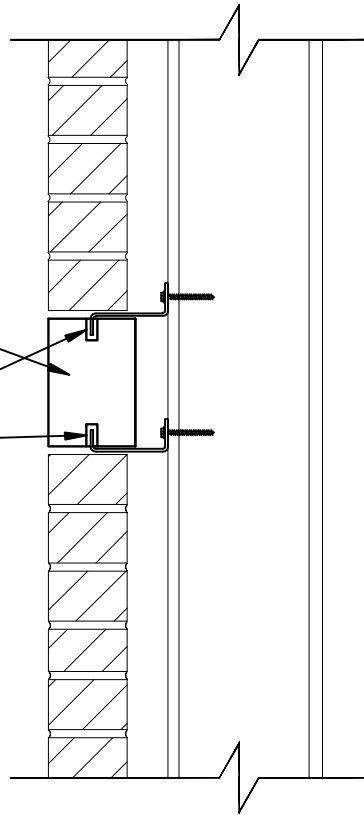

1 BAND CONNECTION
SCALE: 1-1/2"=1'-0"

