

TOP CONNECTION:
BOLT L-ANCHOR TO
CAST-IN INSERT AND
SCREW TO STUD BACKUP.

CAST-IN INSERT

REBAR AS REQUIRED

BOTTOM CONNECTION:
L-ANCHORS GROUTED SOLID
IN CONTINUOUS SLOT AND
SCREW TO STUD BACKUP. 2
PER PIECE @ 5TH POINTS.

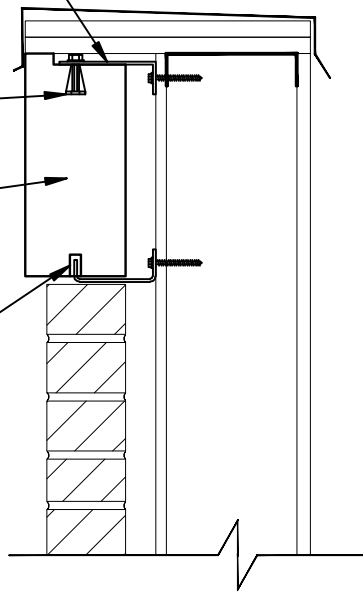

4
BAND

BAND CONNECTION

SCALE: 1-1/2"=1'-0"

