

TOP CONNECTIONS:
CAST-IN EMBED ANGLE.
(2 PER PIECE.)

BENT PLATE WELDED TO
EMBED ANGLE BOLT TO
CIP BACKUP.

REBAR AS REQUIRED

BOTTOM CONNECTIONS:
L-ANCHOR GROUTED SOLID
IN SLOT AND BOLT TO
CIP BACKUP. MIN. 2 PER
PIECE

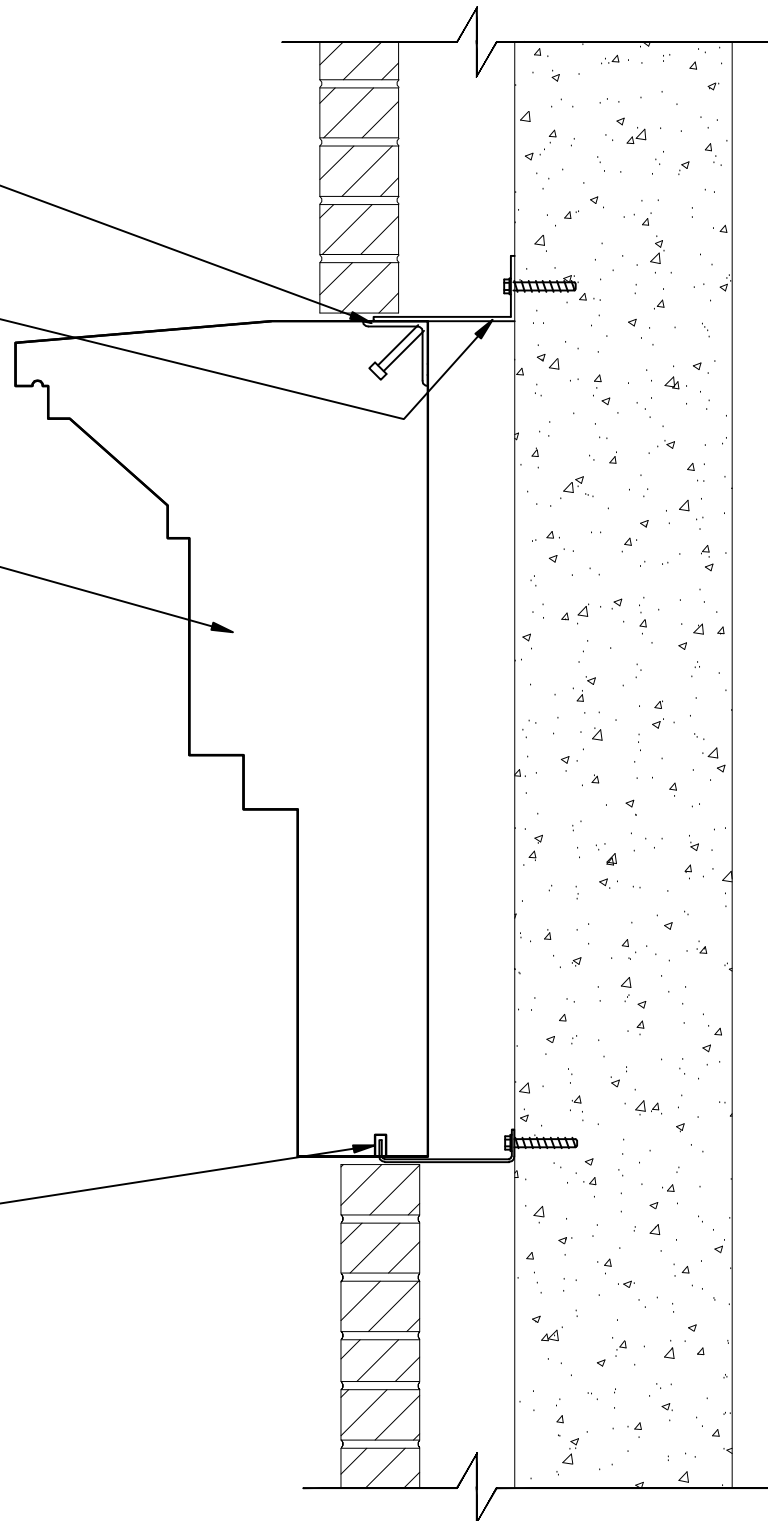

5 BAND CONNECTION
SCALE: 1-1/2"=1'-0"

