

TOP CONNECTION:
L-ANCHOR GROUDED SOLID
IN PROVIDED SLOT AND
BOLT TO CMU BACKUP.

REBAR AS REQUIRED

BOTTOM CONNECTION:
L-ANCHOR GROUDED SOLID
IN PROVIDED SLOT AND
BOLT TO FOUNDATION
BELOW.

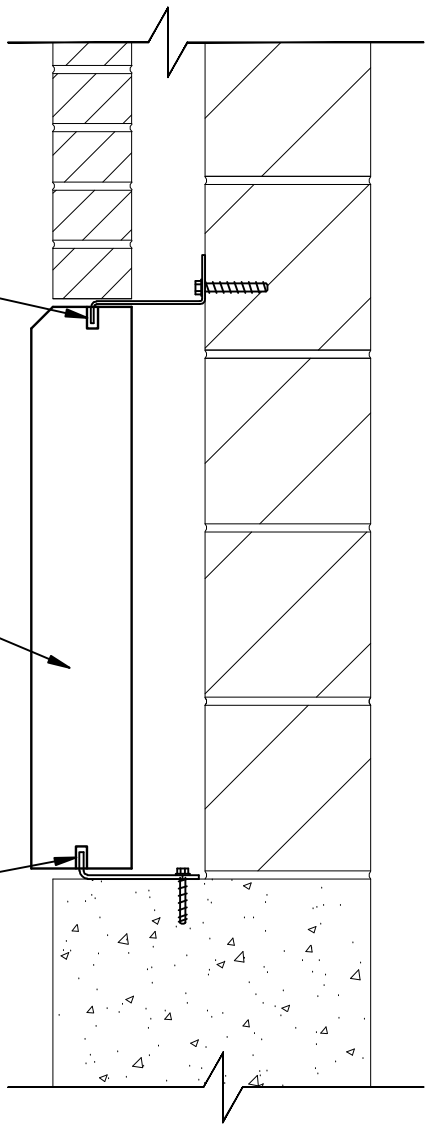

5
BP

BASE PANEL CONNECTION

SCALE: 1-1/2"=1'-0"

