

SECTION A/A

BOTTOM CONNECTION:
STRAP ANCHOR BOLTED TO
INSERT AND BOLTED TO CAST
IN PLACE BACKUP.
CAST IN INSERT (3) PER PIECE.

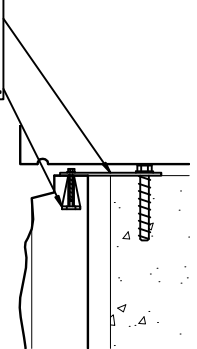

DETAIL B/B

BOTTOM CONNECTION:
THREADED ROD SCREWED INTO
INSERT BELOW AND SET INTO
PROVIDED HOLE ABOVE.
CAST IN INSERT (3) PER PIECE.

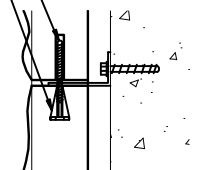

DETAIL C/C

BOTTOM CONNECTION:
L-ANCHOR GROUTED SOLID IN
PROVIDED SLOTS IN STONE AND
BOLTED TO CMU BACKUP. (2)
PER PIECE AT 5TH POINTS OF
STONE.

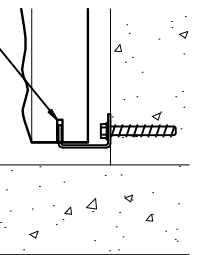

DETAIL D/D