

REBAR AS REQUIRED

CONNECTION:
L-ANCHOR GROUDED
SOLID IN PROVIDED SLOT
AND BOLTED TO CMU
BACKUP. 2 PER PIECE AT
5TH POINTS OF STONE.

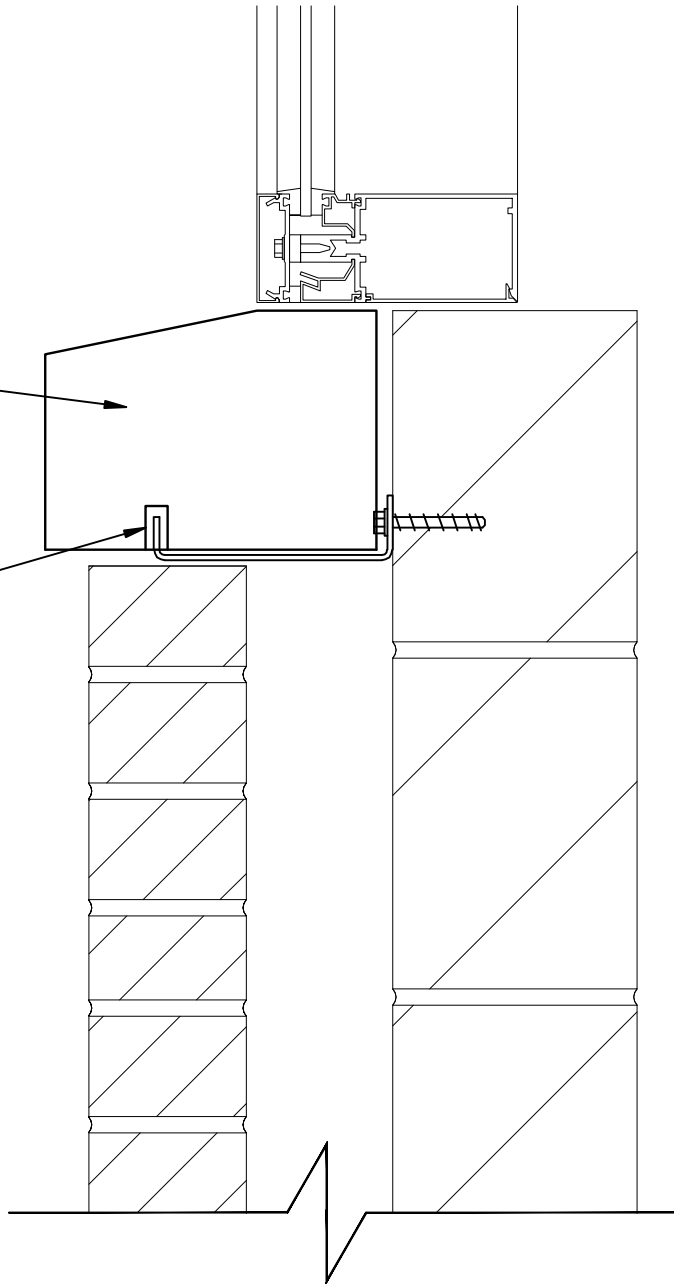

2 SILL CONNECTION
SILL SCALE: 3"=1'-0"

