

TOP CONNECTION:
SPLIT-TAIL GROUDED
SOLID IN PROVIDED
SLOT AND SCREW BACK
TO STUD BACKUP
STRUCTURE.

REBAR AS REQUIRED

BOTTOM CONNECTION:
COIL CAST-IN INSERT

COIL ROD SCREW TO
CAST-IN INSERT AND
GROUT SOLID IN FIELD
DRILLED HOLE IN
FOUNDATION BELOW.

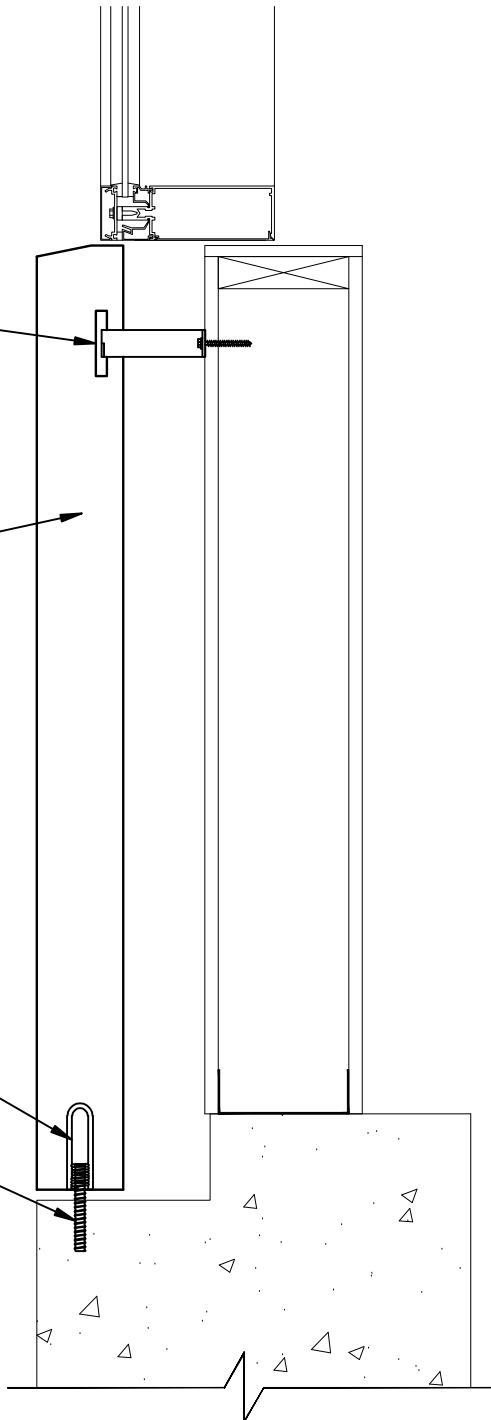

4
BP

BASE PANEL CONNECTION

SCALE: 1-1/2"=1'-0"

